

Current Rating: 3 Amps
 Insulator Resistance: 5000 Megohms min
 Contact Resistance: 20m ohms max.
 Dielectric Withstanding: 1000 V AC
 Operating Temperature: -40° ~ +105° C
 Contact Material: Copper Alloy
 Insulator Material: Polyester, UL 94V-0
 Standard: PBT

Finish: Gold Plated or Duplex Plated
 Standard: Gold Flash all over

Note:
 Duplex Plating: Gold Plated on contact area,
 Tin on solder area

Insulator Material: Polyester, UL 94V-0
 Standard: Nylon-6T
 Standard: Nylon-9T

Max Processing Temp: 230° C for 60 seconds
 Max Processing Temp: 260° C for 10 seconds

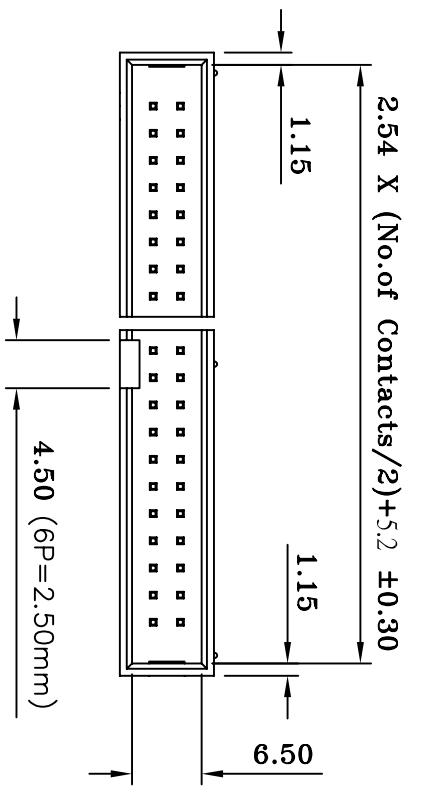
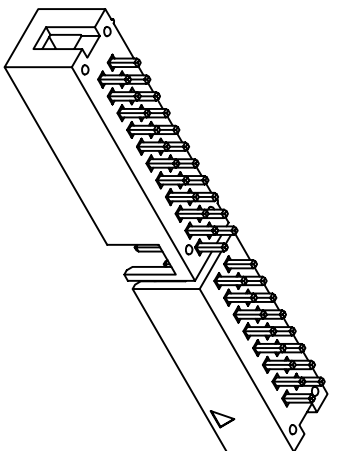

Recommended P.C. Board Hole Layout

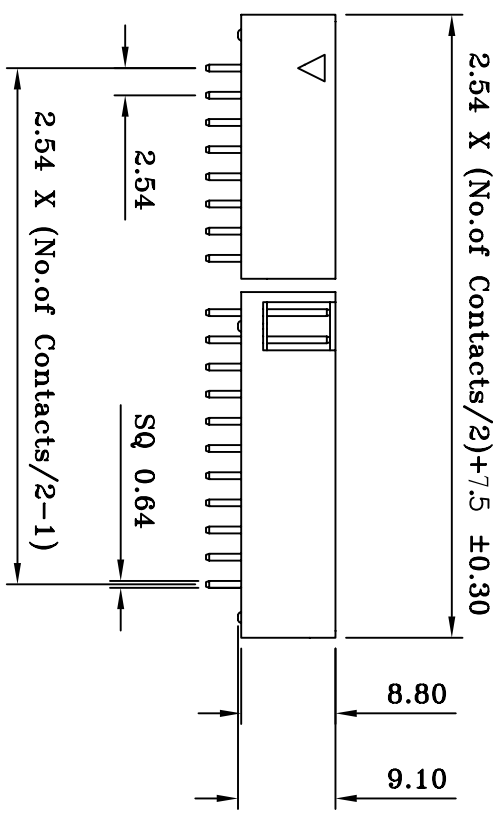
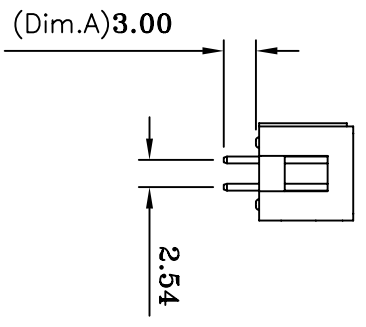
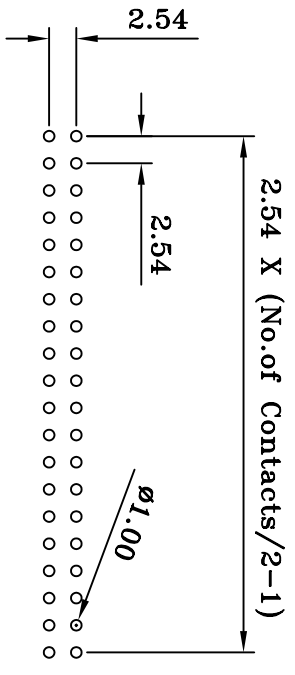

BH11 X X - XX S0 BK X 000 C

1	2	3	4	5	6	7	8
---	---	---	---	---	---	---	---

- Insulator Material:
 - A= P.B.T
 - B= Nylon-9T
 - N= Nylon-6T
 - A=Phosphor Bronze
 - B= Brass
 - Circuits: 06-60 pin
 - Tail Style:
 - S0= Straight
 - Color: BK=Black
- Contact Plated:
 - T=Matte Tin over Nickel
 - W=Matte Tin over Nickel 150u"
 - Y=Bright Tin over Nickel
 - C=Gold Flash
 - F=Gold Flash,Matte Tin 100u"
 - A=Gold 3u"
 - B=Gold 3u",Matte Tin 100u"
 - D=Gold 5u"
- Contact Plated:
 - E=Gold 5u",Matte Tin 100u"
 - G=Gold 10u"
 - J=Gold 10u",Matte Tin 100u"
 - I=Gold 15u"
 - M=Gold 15u",Matte Tin 100u"
 - U=Gold 30u"
 - V=Gold 30u",Matte Tin 100u"
 - Special Options
 - Packing: C=Tray

©: Circuits: 06-64 pin-2008/04/10-C1

©: BH11XX-XXXS0BKX000-2007/03/27-C



CONN TOP
COMPONENT INC.

PART NO
BH11XX-XXXS0BKX000C

.X ±0.3
.XX ±0.20
.XXX ±0.100

BOM 1: BH11X-XXXBKH0
2: QT-0.64X11.60BN
3:

DRAWING NO
DRAWN BY

BH-00048
LIN

EDITION: C2
2008/11/14

ITEM: BH
SCALE: 1:1

TEL:(02)86481727 FAX:(02)86482427

APPROVAL BY

UNIT: m.m