

**MATERIALS:**  
 INSULATOR:P.B.T.30%GLASS FIBER, UL94V-0  
 CONTACT MATERIAL:BRASS OR PHOSPHOR  
 BRONZE,GOLD FLASH OVER NICKEL  
**ELECTRICAL:**  
 CURRENT RATING:1AMP DC  
 INSULATION RESISTANCE:3000MΩ MIN.  
 CONTACT RESISTANCE:30mΩ MAX.  
 DIELECTRIC WITHSTANDING:500V AC  
 OPERATING TEMPERATURE:-40°C~+105°C  
 TERMINATED WITH 1.27mm PITCH FLAT RIBBON CABLE.

DIMENSION					
CONTACT	A	B	CONTACT	A	B
06P	12.18	05.08	20P	29.96	22.86
08P	14.72	07.62	24P	35.04	27.94
10P	17.26	10.16	26P	37.58	30.48
12P	19.80	12.70	30P	42.66	35.56
14P	22.34	15.24	34P	47.74	40.64
16P	24.88	17.78	40P	55.36	48.26
18P	27.42	20.32	50P	68.06	60.96

FC - 12 - XX B0 BK N 000 X  
 1 2 3 4 5 6

- Circuits: 06 to 50pin
- Material:
  - B0=Brass 4kg
  - B4=Brass 4kg
  - B6=Brass 6kg
  - P0=Phosphor Bronze 4kg
  - P4=Phosphor Bronze 6kg
  - P6=Phosphor Bronze 6kg
  - Color: BK=Black GR=Gray
- Contact Plated:
  - T=Matte Tin over Nickel
  - W=Matte Tin over Nickel 150u"
  - Y=Bright Tin over Nickel
  - C=Gold Flash
  - F=Gold Flash,Tin 100u"
  - A=Gold 3u"
  - B=Gold 3u",Ni 50u"
- Special Options
  - D=Gold 5u"
  - E=Gold 5u",Ni 50u"
  - G=Gold 10u"
  - J=Gold 10u",Ni 50u"
  - L=Gold 15u"
  - M=Gold 15u",Ni 50u"
  - U=Gold 30u"
  - V=Gold 30u",Ni 50u"
  - N=Gold Flash , Ni
- Packing:
  - C= Tray
  - N= Top & Reel

①:FC-12-XXB0BKN000C-2009/04/06-C4  
 ②:3.6P&44P-Delete-2008/09/30-C3  
 ③:FC-12-XXB0BKN000-2008/01/14-C2  
 ④:3.55-2007/12/14-C1  
 ⑤:A-2007/04/23-C

CONN TOP COMPONENT INC.		PART NO	FC-12-XXB0BKN000X	X	±0.3
1: FC-12-XXGRH0	DRAWING NO	FC-00089	EDITION: C5	XX	±0.20
2: FC-14-XXBKNV0	DRAWN BY	GARY	2009/04/09	XXX	±0.100
3: FCT-B	APPROVAL BY			FC	SCALE: 1:1
TEL:(02)86481727 FAX:(02)86482427				UNIT: m.m	

**NOTE:**

- 1.10 sprocket hole pitch cumulative tolerance±0.2
- 2.Carrier camber is 1mm in 100mm
- 3.A0 and B0 measured on a plane 0.3mm above the bottom of the pocket
- 4.K0 measured from a plane on the inside bottom of the pocket to the top surface of the carrier
- 5.All dimensions meet EIA-481-2 requirements
- 6.13"1R= 5.5M 250PCS

CIRCUITS	W	B0	F
06 pin	32	12.5	14.2
08 pin	32	15.0	14.2
10 pin	44	17.6	20.2
12 pin	44	20.3	20.2
14 pin	44	22.6	20.2
16 pin	44	25.2	20.2
18 pin	56	27.7	26.2
20 pin	56	30.3	26.2
24 pin	56	35.3	26.2
26 pin	56	37.9	26.2
30 pin	72	43.0	34.2
34 pin	72	48.0	34.2
40 pin	88	55.7	42.2
50 pin	88	68.4	42.2

FC-11-XXXB0BK000N

FC-12-XXXB0BK000N

FC-11-XXP0BKX000I

FC-12-XXP0BKX000I

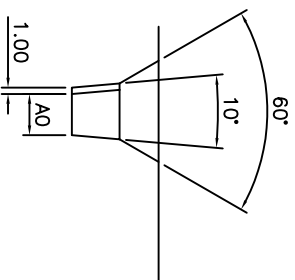
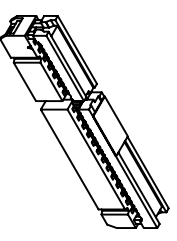
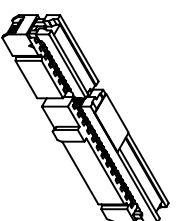
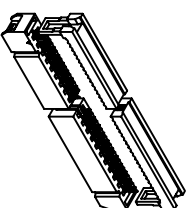
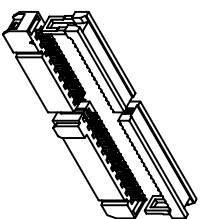

DEVICE TYPE: FC-1X-XXXB0BK000X MATERIAL :

ITEM	A0	K0	P	E	D2	P0	P2
DIM	6.3 <sup>+0.1</sup> <sub>-0.1</sub>	13.3 <sup>+0.1</sup> <sub>-0.1</sub>	20 <sup>+0.1</sup> <sub>-0.1</sub>	1.75 <sup>+0.1</sup> <sub>-0.1</sub>	1.5 <sup>+0.1</sup> <sub>-0.0</sub>	4.0 <sup>+0.1</sup> <sub>-0.1</sub>	2.0 <sup>+0.1</sup> <sub>-0.1</sub>

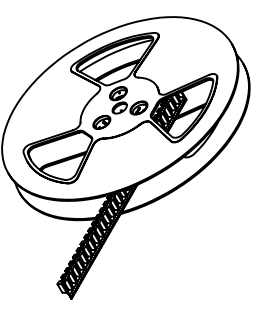
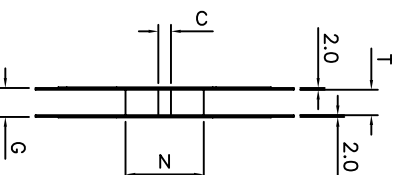
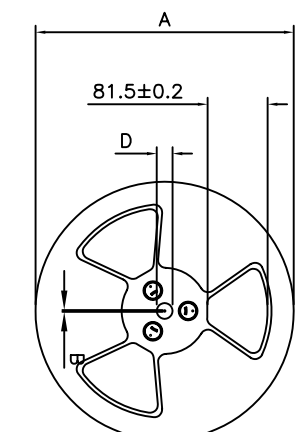
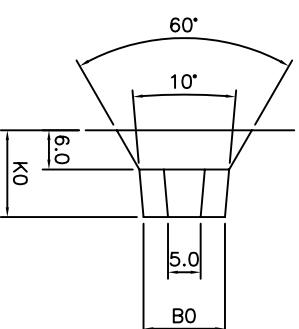
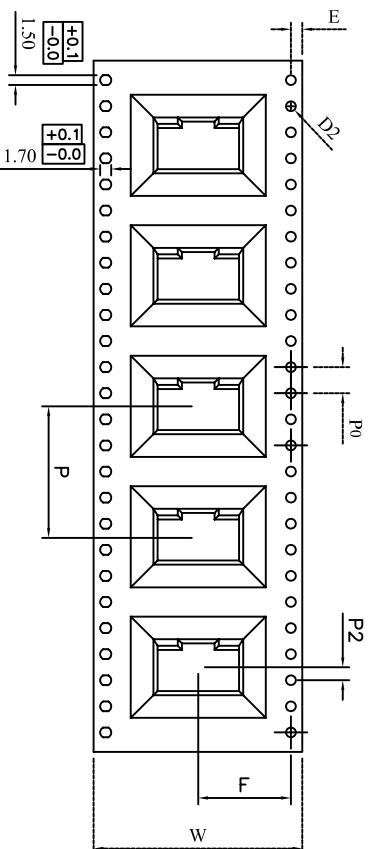

Dimension						Carrier Tape	
A	B±0.5	C±0.2	D±1.0	N±1.0	T±0.1	G±0.1	W
330	2.2	13	20.2	100	8.5	13.1	8
330	2.2	13	20.2	100	12.5	17.1	12
330	2.2	13	20.2	100	17	21.1	16
330	2.2	13	20.2	100	24.5	29.1	24
330	2.2	13	20.2	100	32.5	37.0	32
330	2.2	13	20.2	100	44.5	49.1	44
330	2.2	13	20.2	100	56.5	61.1	56
330	2.2	13	20.2	100	72.5	77.1	72
330	2.2	13	20.2	100	88.5	93.1	88



CONN TOP  
COMPONENT INC.

PART NO

FC-1X-XXXB0BK000X  
(T&R)

.X  
±0.02

.XX  
±0.02  
.XXX  
±0.02

材質

DRAWING NO

BOX-00044

EDITION: C

ITEM: TR

適用產品

DRAWN BY

GARY

2009/04/09

SCALE: 1:1

零件編號

APPROVAL BY

1417

UNIT: m.m