

**MATERIALS:**  
 INSULATOR:P.B.T.30%GLASS FIBER,UL94V-0  
 NSR:P.C. 0%GLASS FIBER,UL94V-2  
 CONTACT MATERIAL:BRASS OR PHOSPHOR BRONZE,  
 GOLD FLASH OVER NICKEL

**ELECTRICAL:**  
 CURRENT RATING:1AMP.  
 INSULATION RESISTANCE:1000M Ω MIN.  
 DIELECTRIC WITHSTANDING:500VAC  
 OPERATING TEMPERATURE:-45°C~+85°C

DIMENSION		
CONTACT	Dim.A	Dim.A
10 pin	15.40	35.40
14 pin	19.40	45.40
16 pin	21.40	49.40
20 pin	25.40	

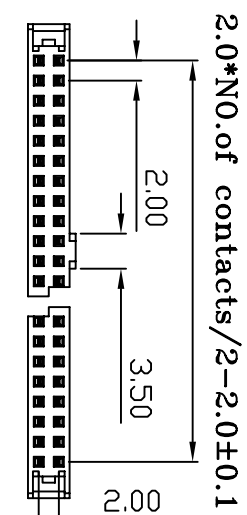
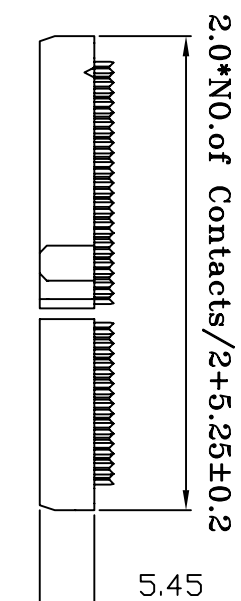
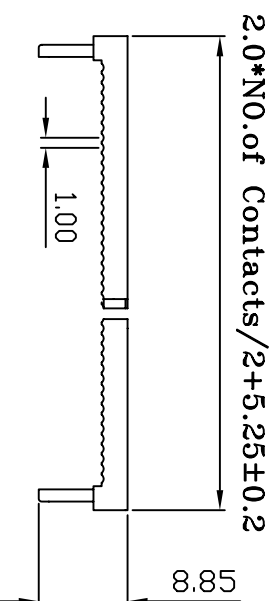
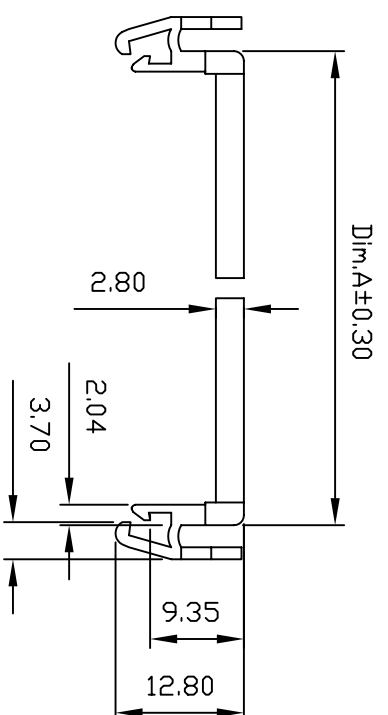
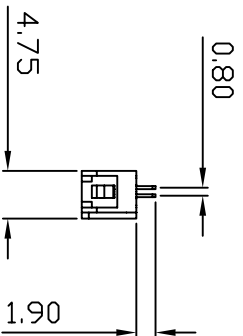
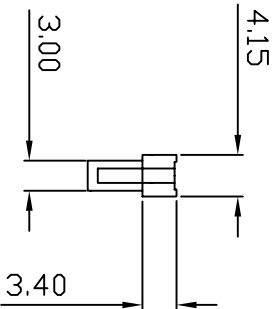
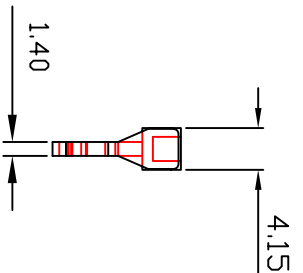
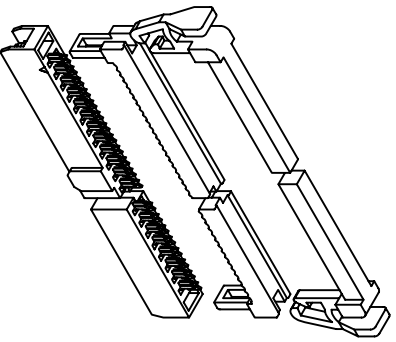

FC-215 - XX P0 BK C 000 C  
 1 2 3 4 5 6

1. Rev Row: 06 to 68pin
2. Material:  
P0=Phosphor Bronze
3. Color: BK=Black  
GR=Gray

4. Contact Plated:  
T=Tin over Nickel  
C=Gold Flash  
F=Gold Flash,Tin 100u"  
A=Gold 3u"  
B=Gold 3u",Ni 50u"  
D=Gold 5u"  
E=Gold 5u",Ni 50u"

5. Special Options  
G=Gold 10u"  
J=Gold 10u",Ni 50u"  
L=Gold 15u"  
M=Gold 15u",Ni 50u"  
V=Gold 30u",Ni 50u"  
N=Gold Flash , Ni 50u"  
6. Packing: C=Tray



CONN TOP  
COMPONENT INC.

PART NO

FC-215-XXP0BKC000C

X  
±0.30

.XXX  
±0.20  
ITEM: FA

BOM

- 1: FC-24-XXBRM0
- 2: FC-25-XXBRNSR
- 3: FC-21-XXBK10
- 4: FAT-AP

DRAWING NO

FA-00053

EDITION: C

SCALE: 1:1

DR

DRAWN BY

GARY

2008/09/30

APPROVAL BY

UNIT: m.m

Tel: (02)86481727 FAX: (02)86482427