

**MATERIALS:**  
 INSULATOR:P.B.T.30%GLASS FIBER, UL94V-0  
 CONTACT MATERIAL:BRASS OR PHOSPHOR  
 BRONZE, GOLD FLASH OVER NICKEL

**ELECTRICAL:**  
 CURRENT RATING:1AMP DC  
 INSULATION RESISTANCE:5000MQ MIN.  
 CONTACT RESISTANCE:30mΩ MAX.  
 DIELECTRIC WITHSTANDING:1000V AC  
 OPERATING TEMPERATURE:-40°C~+105°C  
 TERMINATED WITH 1.27mm  
**PITCH FLAT RIBBON CABLE.**

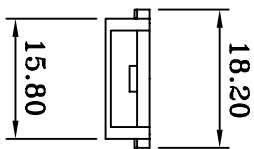

CONTACTS	A	B
FD-82-24B0BK000	35.88	27.94
FD-82-28B0BK000	40.96	33.02
FD-82-32B0BK000	46.04	38.10
FD-82-36B0BK000	51.12	43.18
FD-82-40B0BK000	56.20	48.26

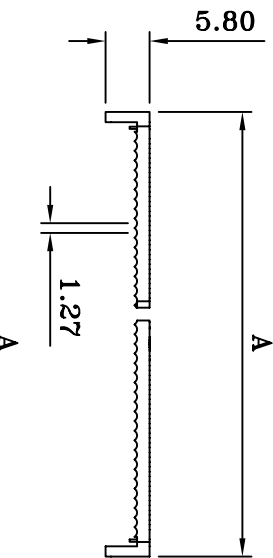
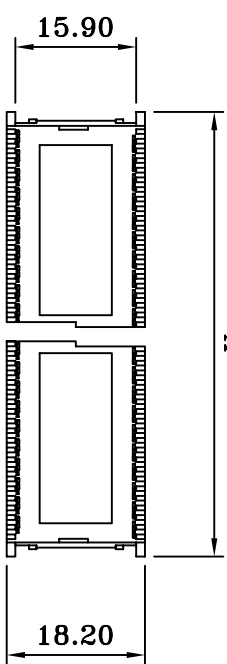

Recommended P.C. Board  
 Hole Layout

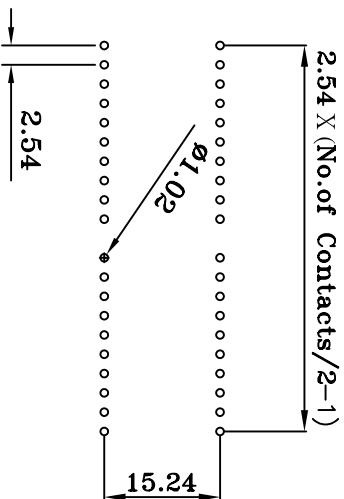
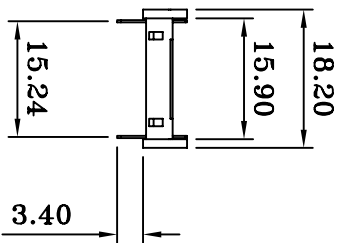
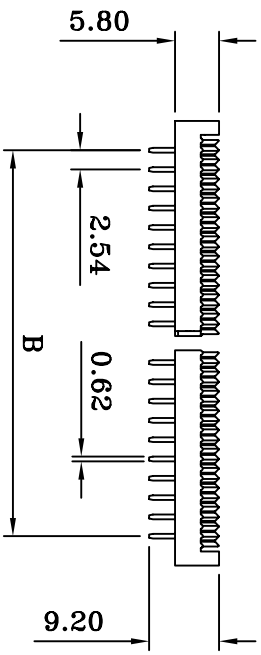

FD-82-XX B0 GR N 000  
 1 2 3 4 5

(RoHS Compliant)

- Circuits: 24 to 40pin
- Taill Style:  
 B0= Brass  
 P0= Phosphor Bronze
- Color:  
 BK=Black  
 GR=Gray
- Contact Plated:  
 T=Matte Tin over Nickel  
 W=Matte Tin over Nickel  
 Y=Brighte Tin over Nickel  
 C=Gold Flash  
 F=Gold Flash,Tin 100u"  
 A=Gold 3u",Ni 50u"  
 B=Gold 3u",Ni 50u"  
 D=Gold 5u"
- E=Gold 5u",Ni 50u"  
 G=Gold 10u"  
 J=Gold 10u",Ni 50u"  
 L=Gold 15u"  
 M=Gold 15u",Ni 50u"  
 U=Gold 30u"  
 V=Gold 30u",Ni 50u"  
 N=Gold Flash, Ni



CONN TOP  
 COMPONENT INC.

PART NO FD-82-XXB0GRN000

X ±0.2 X ±0.2 XX ±0.2

1: FD-81-XXGRH0

DRAWING NO FDL-00009 EDITION: C ITEM: FDL

2: FD-84-XXGRM1

DRAWN BY GARY 2007/06/13 SCALE: 1:1

3: FDT-B

APPROVAL BY

TEL: (02)86481727 FAX: (02)86482427

UNIT: m.m