

Recommended P.C. Board
SMD Layout
A TYPE

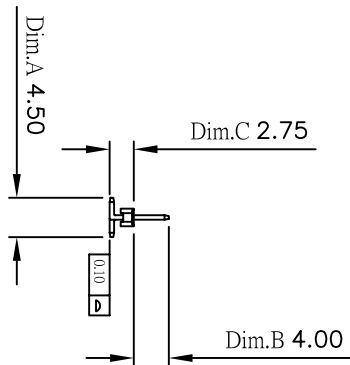

Recommended P.C. Board
SMD Layout
B TYPE

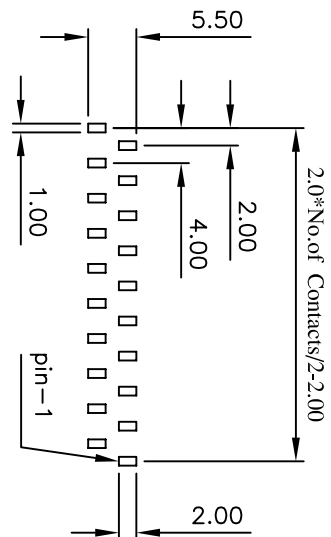
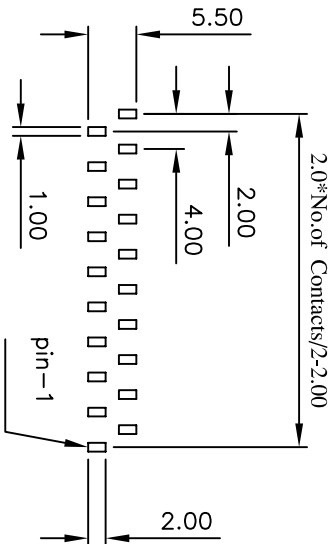
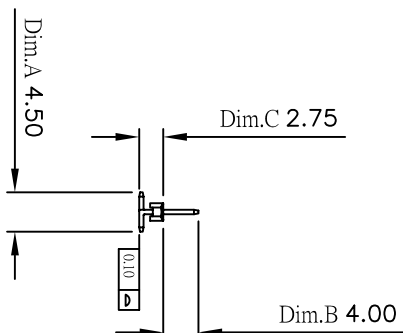
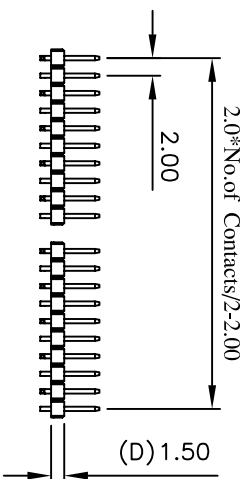

(RoHS Compliant)

H2 N 15 X - 1 XX D0 BK X 000 X

1 2 3 4 5 6 7 8

1. Insulator Material:

N= Nylon-6T

2. P= Phosphor Bronze

Blank= Brass

3. Per Row 03~40 pin

4. TAIL STYLE:

DA= S.M.D A Type

DB= S.M.D B Type

5. Color: BK=Black

6. Contact Plated:

T=Matte Tin over Nickel

W=Matte Tin over Nickel

Y=Bright Tin over Nickel

C=Gold Flash

F=Gold Flash,Matte Tin 100u"

A=Gold 3u"

B=Gold 3u",Matte Tin 100u"

D=Gold 5u"

E=Gold 5u",Matte Tin 100u"

G=Gold 10u"

J=Gold 10u",Matte Tin 100u"

L=Gold 15u"

M=Gold 15u",Matte Tin 100u"

U=Gold 30u"

V=Gold 30u",Matte Tin 100u"

7. Special Options

D= Box

8. Packing:

B= Tube



CONN TOP
COMPONENT INC.

1: H2N15-1XXBKHX0

BOM 2: QT-0.50X8.50BN

3: 0

Tel: (02)86481727 FAX: (02)86482427

Finish: Tin, Gold Plated
Standard: Gold Flash all over

Current Rating: 2 Amps
Insulator Resistance: 5000 Megohms min
Contact Resistance: 20 m ohms max
Dielectric Withstanding: 500 V AC
Operating Temperature: -40° ~ +105° C
Max Processing Temp: 230° C for 60 seconds
Max Processing Temp: 260° C for 10 seconds
Contact Material: Copper Alloy
Insulator Material: Polyester, UL 94V-0
Standard: Nylon-6T

PART NO	H2N15X-1XXD0BKX000X	.X	.XXX
DRAWING NO	PHA-00064	±0.3	±0.100
DRAWN BY	GARY	EDITION: C1	ITEM: PHA
APPROVAL BY		2008/05/14	SCALE: 1:1
			UNIT: m.m