

Current Rating: 2 Amps
 Insulator Resistance: 5000 Megohms min
 Contact Resistance: 20 m ohms max
 Dielectric Withstanding: 500 V AC
 Operating Temperature: -40° ~ +105° C
 Max Processing Temp: 230° C for 60 seconds
 Max Processing Temp: 260° C for 10 seconds
 Contact Material: Copper Alloy
 Insulator Material: Polyester, UL 94V-0
 Standard: Nylon-6T
 Finish: Tin, Gold Plated
 Standard: Gold Flash all over

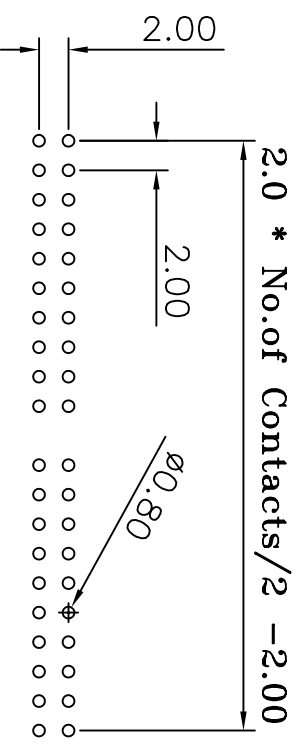
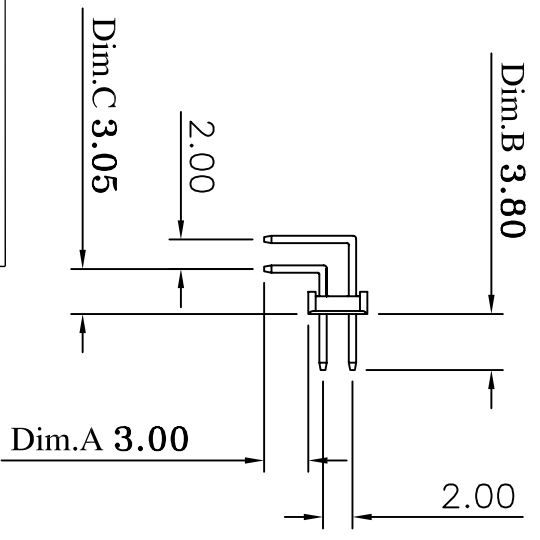
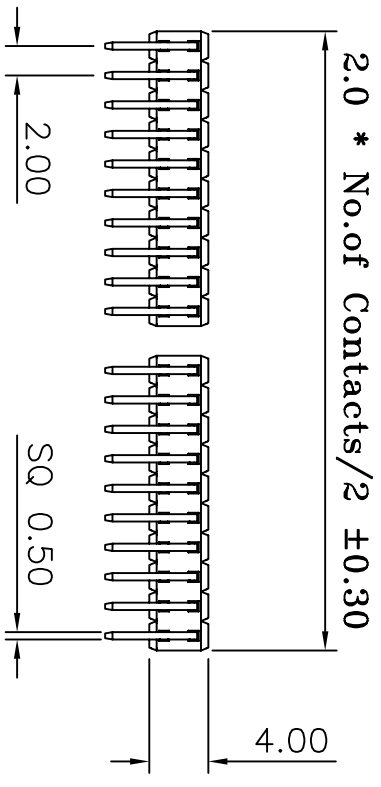

Recommended P.C. Board
 Hole Layout

(RoHS Compliant) H2 N 15 X - 2 XX R0 BK X 000 X
 1 2 3 4 5 6 7 8

- Insulator Material:
 N= Nylon-6T
 P= Phosphor Bronze
 Blank= Brass
 3. Per Row 02~40 pin
 4. Tgill Style:
 R0= Right Angle
 WH=Black
 WH=White
- Contact Plated:
 T=Matte Tin over Nickel
 W=Matte Tin over Nickel 150u"
 Y=Bright Tin over Nickel
 C=Gold Flash
 F=Gold Flash,Matte Tin 100u"
 A=Gold 3u"
 B=Gold 3u",Matte Tin 100u"
- Special Options
 D=Gold 5u"
 E=Gold 5u",Matte Tin 100u"
 G=Gold 10u"
 J=Gold 10u",Matte Tin 100u"
 L=Gold 15u"
 M=Gold 15u",Matte Tin 100u"
 U=Gold 30u"
 V=Gold 30u",Matte Tin 100u"
- Packging:
 A= PE Bag
 D= Box

©:H2X15-2XXR0BKX000X-2008/05/15-C1
 ©:H2X15-2XXR0BKX000-2007/01/25-C

CONN TOP COMPONENT INC.

1: H2N15-2XXBKH0
 2: QT-0.50X10.50BN
 3: QT-0.50X14.50BN

TEL:(02)86481727 FAX:(02)86482427

PART NO	H2N15X-2XXR0BKX000X	.X	.XX	.XXX
DRAWING NO	PHA-00032	±0.3	±0.20	±0.100
DRAWN BY	GARY	EDITION: C2	SCALE: 1:1	ITEM: PHA
APPROVAL BY		2008/07/04		UNIT: m.m