

**Current Rating:** 2 Amps  
**Insulator Resistance:** 1000 Megohms min  
**Contact Resistance:** 20 m ohms max  
**Dielectric Withstanding:** AC 500 V  
**Operating Temperature:** - 40° ~ +85° C  
**Max Processing Temp:** 230° C for 60 seconds  
**Max Processing Temp:** 260° C for 10 seconds  
**Contact Material:** Copper Alloy  
**Insulator Material:** Polyester, UL 94V-0  
**Standard:** Nylon-6T

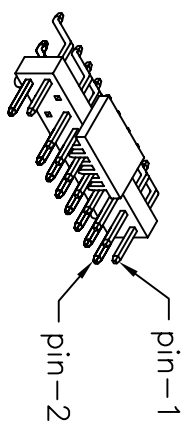

Recommended P.C. Board  
 SMD Layout

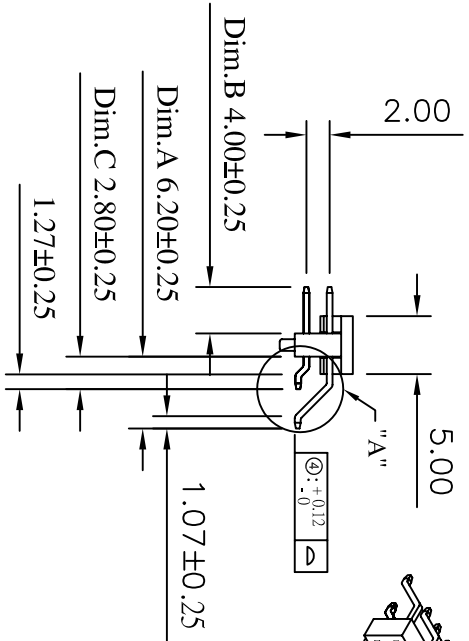
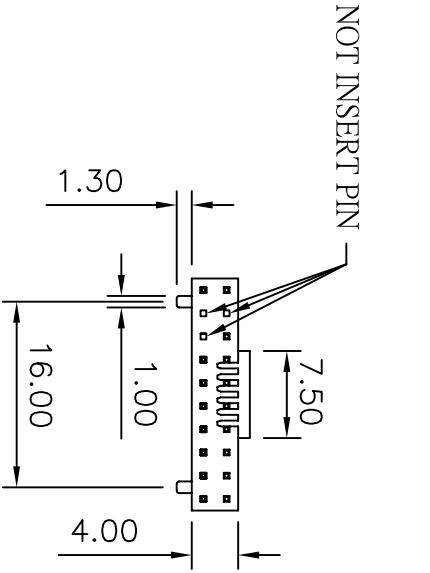
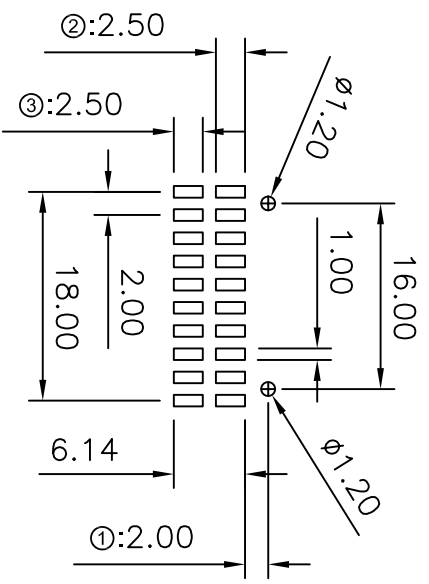

(RoHS Compliant) H2 N 20 - 2 10 D3 BK X E01 X  
 1 2 3 4 5 6 7

- Insulator Material: 5. Contact Plated:
  - N= Nylon-6T
  - T=Matte Tin over Nickel
  - W=Matte Tin over Nickel 150u"
  - Y=Brighe Tin over Nickel
  - C=Gold Flash
  - D3= S.M.D with Peg Type
  - F=Gold Flash/Matte Tin 100u"
  - A=Gold 3u"
  - B=Gold 3u",Matte Tin 100u"
  - D=Gold 5u"
- Circuits: 20 pin
- Taill Style:
  - G=Gold 10u"
  - J=Gold 10u",Matte Tin 100u"
  - L=Gold 15u"
  - M=Gold 15u",Matte Tin 100u"
  - U=Gold 30u"
  - V=Gold 30u",Matte Tin 100u"
- Color:
  - BK=Black
  - WH=White
- Packing:
  - E= CAP + Top & Reel
  - F= CAP + Tube
  - G= CAP + Tray
  - H= CAP + Bag

①: 2007/06/29-C1
②: 1.78-2007/05/22-C
③: 2.03-2007/05/22-C
④: 3.30-2007/05/22-C

CONN TOP COMPONENT INC.		PART NO H2N20-210D3BKXE01X		.X ±0.3		.XX ±0.2		.XXX ±0.1	
DRAWING NO PHA-00187		EDITION: C3		ITEM: PHA		SCALE: 1:1		UNIT: m.m	
DRAWN BY GARY		2008/04/23							
APPROVAL BY									

TEL: (02)86481727 FAX: (02)86482427