

2.54 * NO.of Contacts/2 +0.5

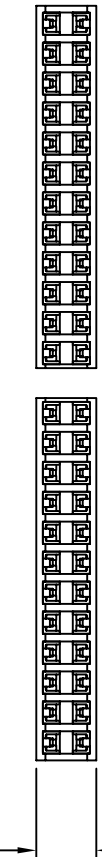
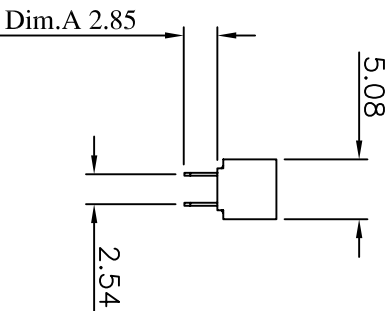
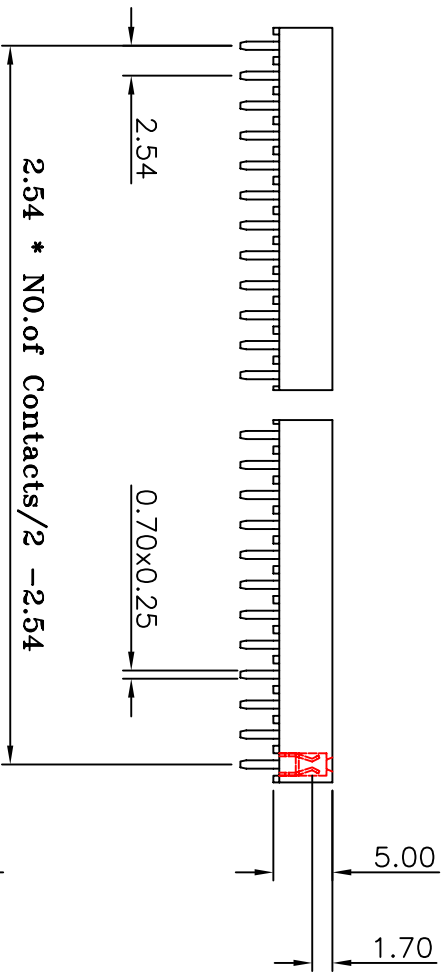
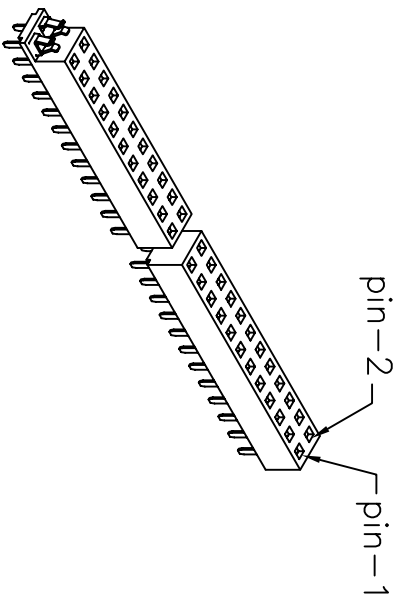
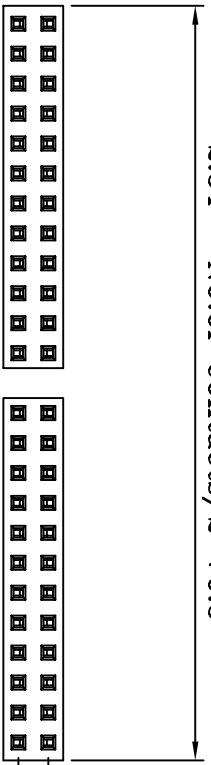

Current Rating: 3 Amps
 Insulator Resistance: 5000 Megohms min
 Contact Resistance: 20 m ohms max
 Dielectric Withstanding: 1000 V AC
 Operating Temperature: -40° ~ +105° C
 Contact Material: Phosphor Bronze
 Insulator Material: Polyester, UL 94V-0
 Standard: PBT

Finish: Tin, Gold Plated
 Standard: Gold Flash all over

Note:
 Duplex Plating: Gold Plated on contact area,
 Tin on solder area

Insulator Material: Polyester, UL 94V-0
 Standard: Nylon-6T

Max Processing Temp: 230° C for 60 seconds
 Max Processing Temp: 260° C for 10 seconds

Recommended P.C. Board
 Hole Layout

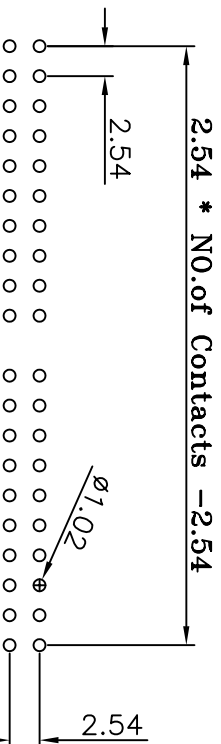

(RoHS Compliant)
 P1 X 50 - 2 XX S0 BK X 000 X
 1 2 3 4 5 6 7

- Standard: A= P.B.T.
 N= Nylon-6T
- Per ROW 03 to 40
- Tail Style:
 S0= Straight
 Color: BK=Black
- Contact Plated:
 T=Matte Tin over Nickel
 W=Matte Tin over Nickel 150u"
 Y=Bright Tin over Nickel
 C=Gold Flash
 F=Gold Flash,Matte Tin 100u"
 A=Gold 3u"
 B=Gold 3u",Matte Tin 100u"
- D=Gold 5u"
 E=Gold 5u",Matte Tin 100u"
 G=Gold 10u"
 J=Gold 10u",Matte Tin 100u"
 L=Gold 15u"
 M=Gold 15u",Matte Tin 100u"
 U=Gold 30u"
 V=Gold 30u",Matte Tin 100u"
- Special Options
 Packing:
 B= Tube
 C= Tray



CONN TOP
 COMPONENT INC.

①:PIX50-2XXS0BKX000X-2007/02/27-C

1:	PIX50-2XXBKH0
2:	PIX50T-253434S
3:	

PART NO	PIX50-2XXS0BKX000X	.X	.XX	.XXX
DRAWING NO	PB-00012	±0.3	±0.20	±0.100
DRAWN BY	GARY	EDITION: C1	SCALE: 1:1	ITEM: PB
APPROVAL BY				UNIT: m.m

TEL:(02)86481727 FAX:(02)86482427