

②:2.54 \* No.of Contacts/2 +0.6 ±0.3

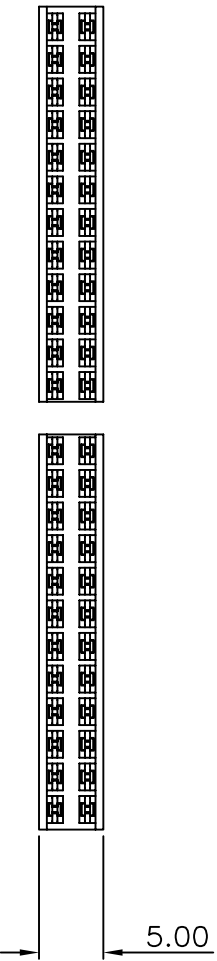
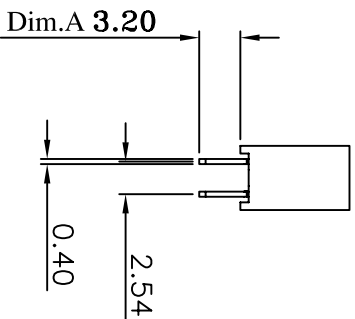
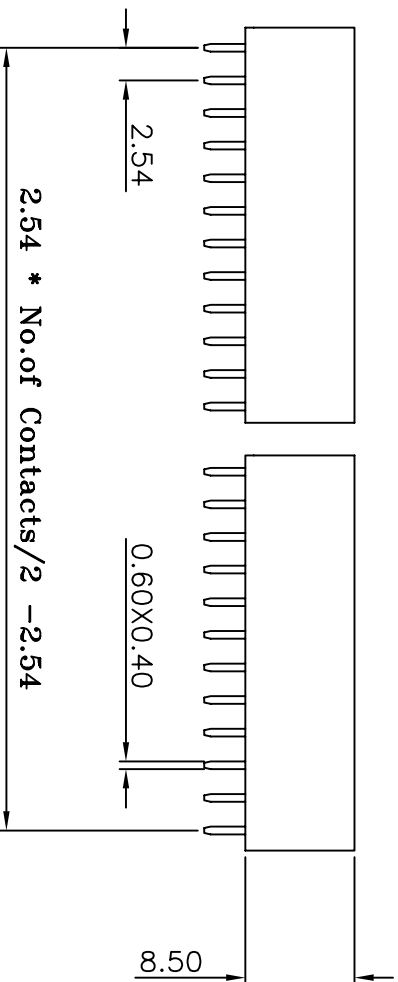
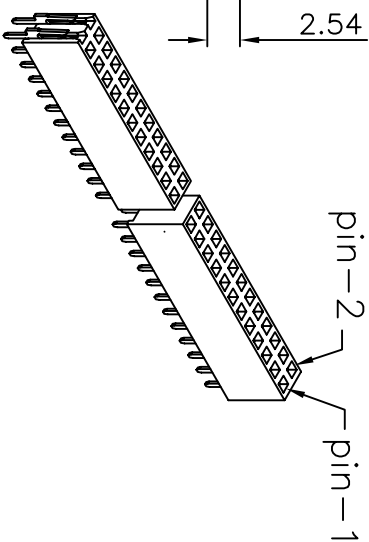
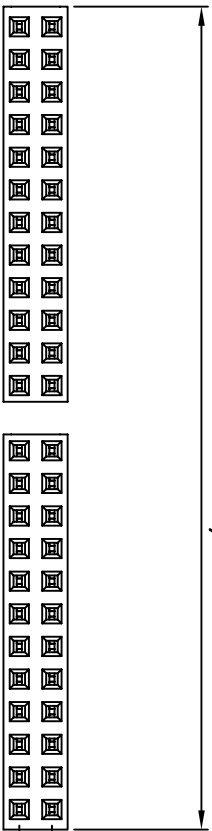

(RoHS Compliant)

P1 X 85 X - 2 XX S0 BK X 000 X  
1 2 3 4 5 6 7 8

- Standard: A= P.B.T.  
N= Nylon-6T  
2. A= Phosphor Bronze  
Blank:=Brass  
3. Per ROW : 02 to 40  
4. Toll Style:  
S0= Straight  
5. Color: BK=Black

- Contact Plated:  
T=Matte Tin over Nickel  
W=Matte Tin over Nickel 150u"  
Y=Bright Tin over Nickel  
C=Gold Flash  
F=Gold Flash,Matte Tin 100u"  
A=Gold 3u"  
B=Gold 3u",Matte Tin 100u"
- D=Gold 5u"  
E=Gold 5u",Matte Tin 100u"  
G=Gold 10u"  
J=Gold 10u",Matte Tin 100u"  
L=Gold 15u"  
M=Gold 15u",Matte Tin 100u"  
U=Gold 30u"  
V=Gold 30u",Matte Tin 100u"
- Special Options  
C= Tray  
D= Box

Current Rating: 3 Amps

Insulator Resistance: 5000 Megohms min

Contact Resistance: 20 m ohms max

Dielectric Withstanding: 1000 V AC

Operating Temperature: -40° ~ +105° C

Contact Material: Copper Alloy

Insulator Material: Polyester; UL 94V-0

Standard: PBT

Finish: Tin,Gold Plated

Standard:Gold Flash all over

Note:

Duplex Plating: Gold Plated on contact area,

Tin on solder area

Insulator Material: Polyester; UL 94V-0

Standard: Nylon-6T

Max Processing Temp: 230° C for 60 seconds

Max Processing Temp: 260° C for 10 seconds

Recommended P.C. Board  
Hole Layout

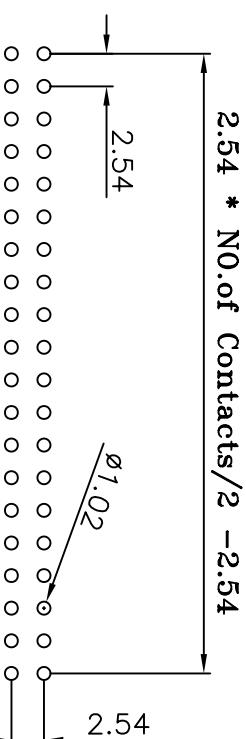

CONN TOP  
COMPONENT INC.

①:P1X85-2XXXS0BKX000X-2008/09/25-C1  
②:2.54\*No.of Contacts/2+0.6-2007/01/16-C  
③:P1X85-2XXXS0BKX000-2007/01/16-C

1:	P1X85-2XXXBKHX0
2:	P1X85T-6237S
3:	

PART NO	P1X85X-2XXXS0BKX000X	X	.XX	.XXX
DRAWING NO	PB-00002	±0.3	±0.20	±0.100
DRAWN BY	GARY	EDITION: C2	SCALE: 1:1	ITEM: PB
APPROVAL BY		2008/12/19		UNIT: m.m

TEL:(02)86481727 FAX:(02)86482427