

②:2.54*No.of Contacts/3 + 0.40

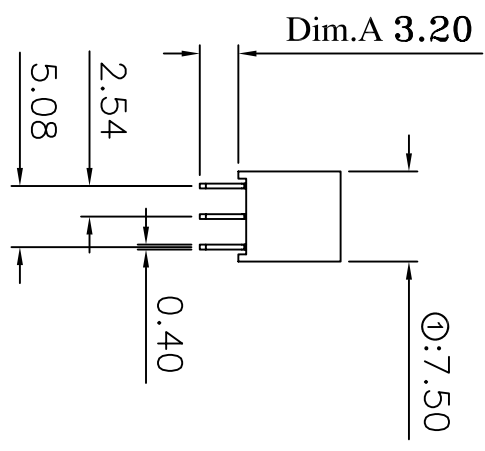
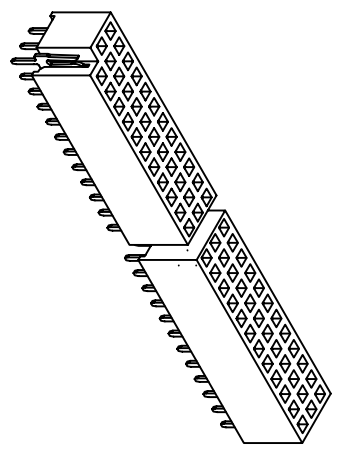
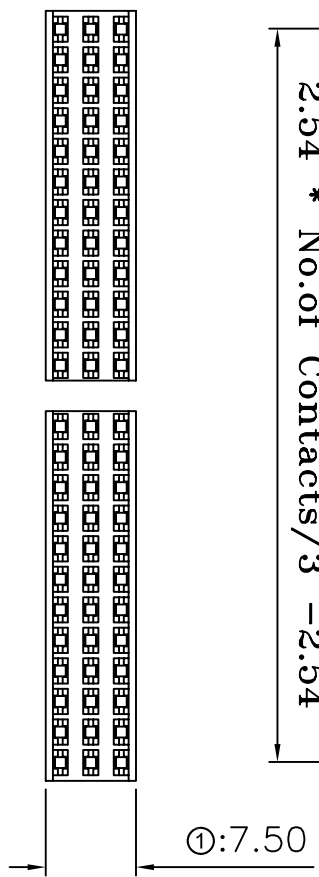
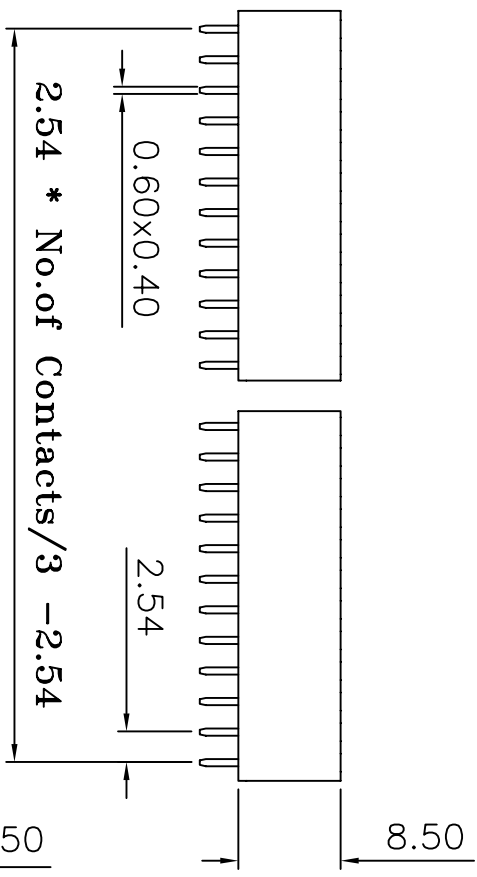
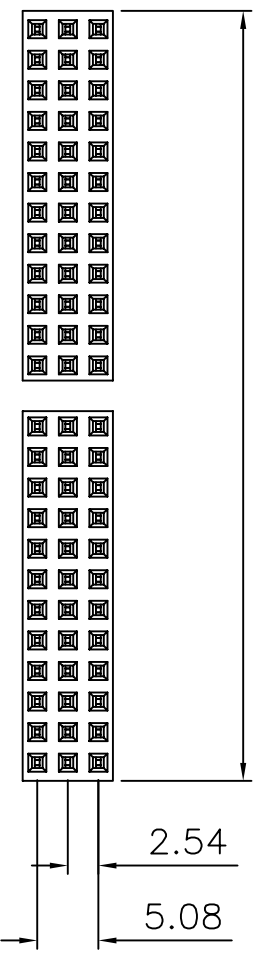

Current Rating: 3 Amps
 Insulator Resistance: 5000 Megohms min
 Contact Resistance: 20 m ohms max
 Dielectric Withstanding: 1000 V AC
 Operating Temperature: -40° ~ +105° C
 Contact Material: Copper Alloy
 Insulator Material: Polyester, UL 94V-0
 Standard: PBT

Finish: Tin, Gold Plated
 Standard: Gold Flash all over
 Note: Duplex Plating: Gold Plated on contact area, Tin on solder area
 Insulator Material: Polyester, UL 94V-0
 Standard: Nylon-6T
 Max Processing Temp: 230° C for 60 seconds
 Max Processing Temp: 260° C for 10 seconds

Recommended P.C. Board
 Hole Layout

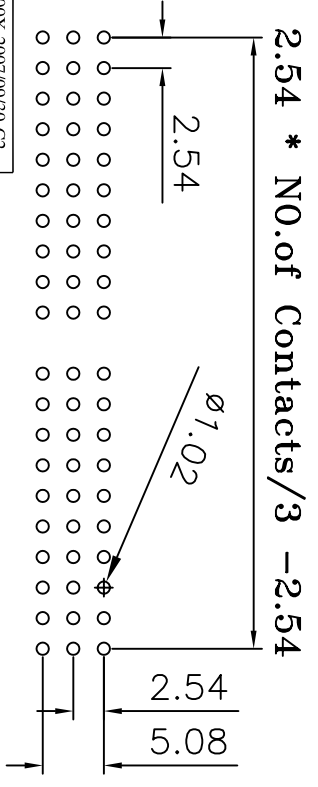

(RoHS Compliant) P1 X 85 X - 3 XX S0 BK X 000 X

- Standard: A= P.B.T.
N= Nylon-6T
- A= Phosphor Bronze
Blank:=Brass
- Per ROW : 02 to 40
Tail Style:
S0= Straight
- Color: BK=Black
6. Contact Plated:
T=Matte Tin over Nickel
W=Matte Tin over Nickel 150u"
Y=Bright Tin over Nickel
C=Gold Flash
F=Gold Flash, Matte Tin 100u"
A=Gold 3u"
B=Gold 3u", Matte Tin 100u"
- D=Gold 5u"
E=Gold 5u", Matte Tin 100u"
G=Gold 10u"
J=Gold 10u", Matte Tin 100u"
L=Gold 15u"
M=Gold 15u", Matte Tin 100u"
U=Gold 30u"
V=Gold 30u", Matte Tin 100u"
8. Special Options
C= Troy
D= Box

①: P1X85-3XXS0BKX000X-2007/09/30-C2	③: 3.30mm-2007/04/03-C
②: P1X85-3XXS0BKX000-2007/04/09-C1	④: 2.54*No.of Contacts/2+0.60 -2007/04/03-C
CONN TOP COMPONENT INC.	
1: P1X85-3XXBKH0	DRAWING NO
2: P1X85T-6237-S	DRAWN BY
3: 0	GARY
TEL:(02)86481727 FAX:(02)86482427	APPROVAL BY

PART NO	P1X85X-3XXS0BKX000X	.X	.XX	.XXX
DRAWING NO	PB-00066	±0.3	±0.20	±0.100
DRAWN BY	GARY	EDITION: C3	ITEM: PB	SCALE: 1:1
APPROVAL BY		2008/12/19	UNIT: m.m	