

2.54 X No.of Contacts/2 +5.08

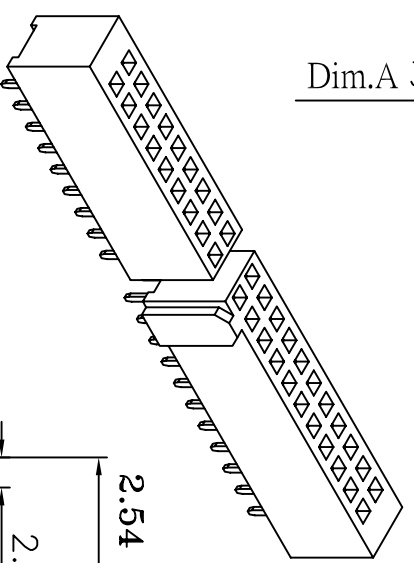

Recommended P.C. Board
Hole Layout

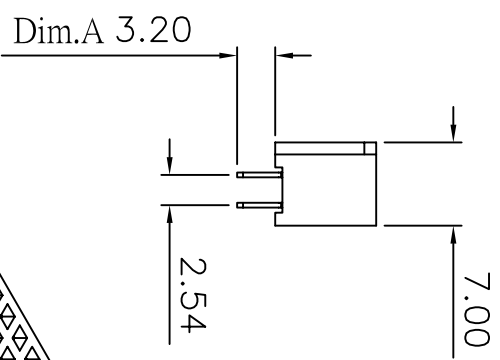
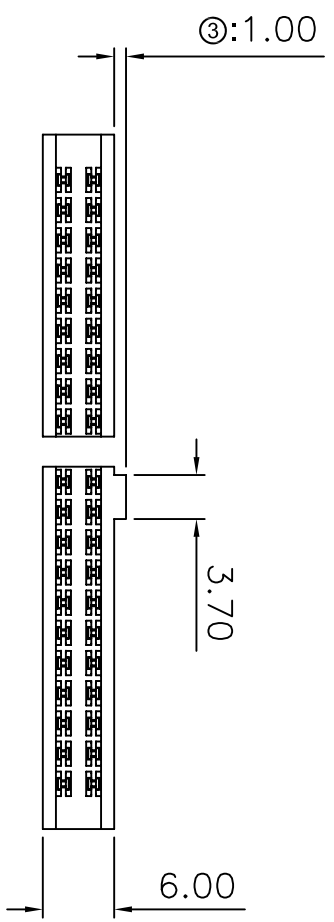
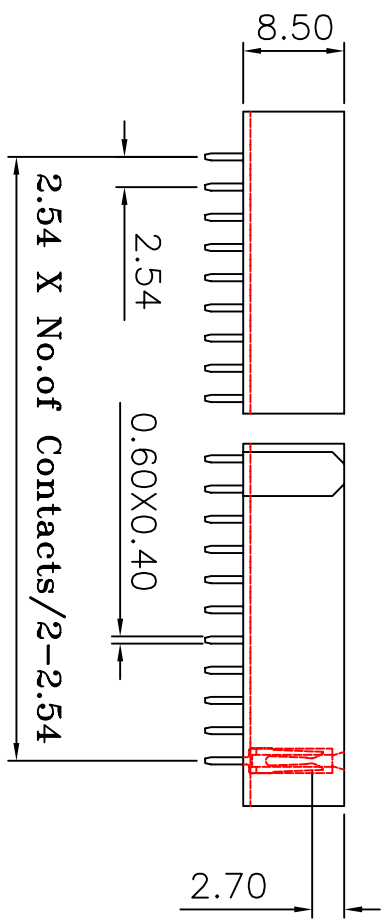
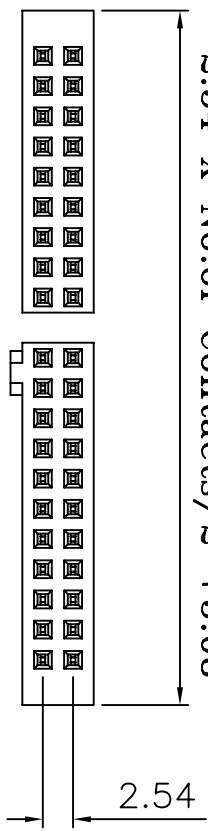
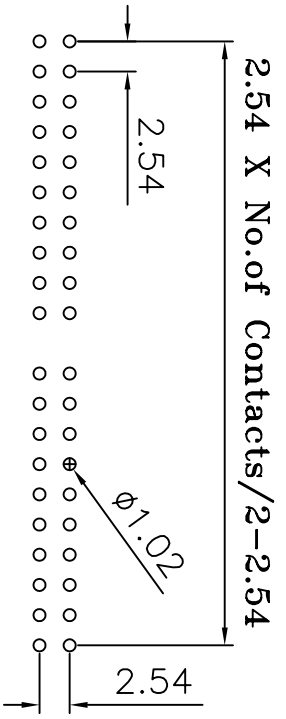

Current Rating: 3 Amps
 Insulator Resistance: 5000 Megohms min
 Contact Resistance: 20 m ohms max
 Dielectric Withstanding: 1000 V AC
 Operating Temperature: -40° ~ +105° C
 Contact Material: Copper Alloy
 Insulator Material: Polyester, UL 94V-0
 Standard: PBT

Finish: Tin, Gold Plated
 Standard: Gold Flash all over

Note:
 Duplex Plating: Gold Plated on contact area,
 Tin on solder area

Insulator Material: Polyester; UL 94V-0
 Standard: Nylon-6T

Max Processing Temp: 230° C for 60 seconds
 Max Processing Temp: 260° C for 10 seconds

(RoHS Compliant) P1 X 87 P X - 2 XX S0 BK X 000 X

- Standard: A= P.B.T.
N= Nylon-6T
 - P=With Key
 - A=Phosphor Bronze
Blank=Brass
 - Per ROW: 02 to 40
 - Toill Style:
S0= Straight
 - Color: BK=Black
- Contact Plated:
T=Matte Tin over Nickel
W=Matte Tin over Nickel 150u"
Y=Bright Tin over Nickel
C=Gold Flash
F=Gold Flash,Matte Tin 100u"
A=Gold 3u"
B=Gold 3u",Matte Tin 100u"
 - Special Options
D=Gold 5u"
E=Gold 5u",Matte Tin 100u"
G=Gold 10u"
J=Gold 10u",Matte Tin 100u"
L=Gold 15u"
M=Gold 15u",Matte Tin 100u"
U=Gold 30u"
V=Gold 30u",Matte Tin 100u"
 - Packing:
B= Tube
C= Tray

③:0.90-2007/08/15-C1

②:P1X87P-2XXS0BKBX000-2007/08/15-C1

①:P1X86P-2XXS0BKBXA01-2007/01/19-C

CONN TOP COMPONENT INC.

BOM 1: P1X87P-2XXS0BKBH0
2: P1X85T-6237S
3:

TEL:(02)86481727 FAX:(02)86482427

PART NO	P1X87PX-2XXS0BKBX000X	X	XXX
DRAWING NO	PB-00057	±0.3	±0.100
DRAWN BY	GARY	EDITION: C2	SCALE: 1:1
APPROVAL BY		ITEM: PB	UNIT: m.m