

2.0 \* No. of contacts/2

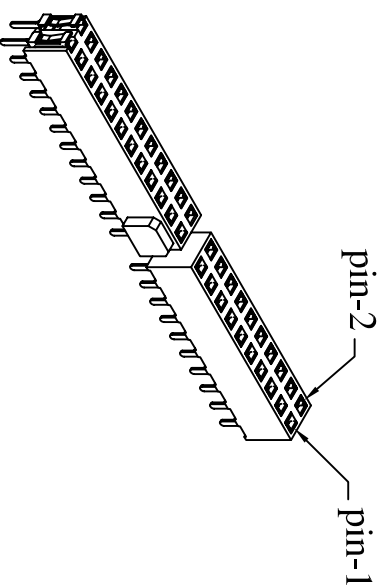

Current Rating: 2 Amps  
 Insulator Resistance: 5000 Megohms min  
 Dielectric Withstanding: 500 V AC  
 Operating Temperature: -40° ~ +125° C  
 Max Processing Temp: 230° C for 60 seconds  
 Max Processing Temp: 260° C for 10 seconds  
 Contact Material: Copper Alloy  
 Insulator Material: Polyester, UL 94V-0 Standard: Nylon-6T

Recommended P.C. Board Hole Layout

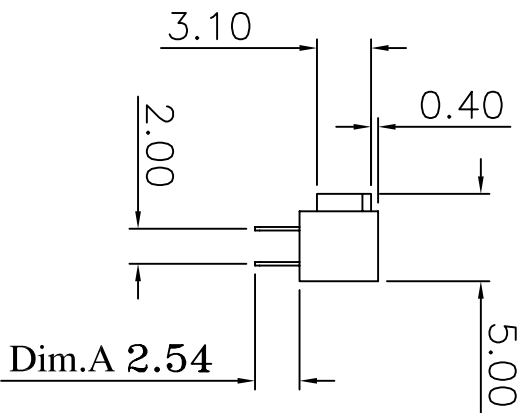
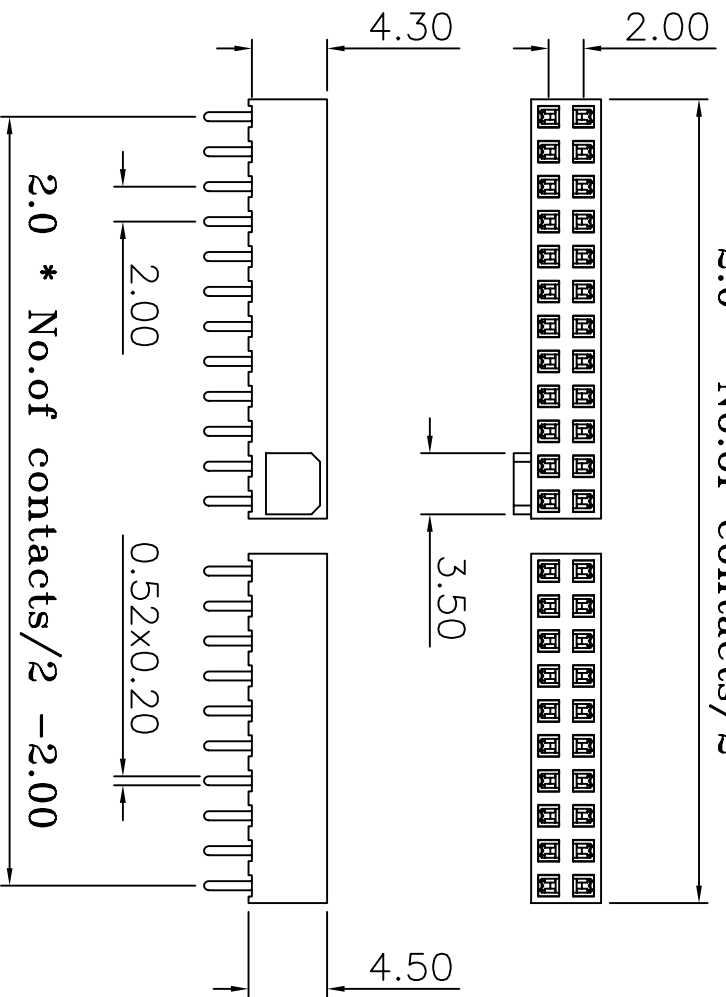
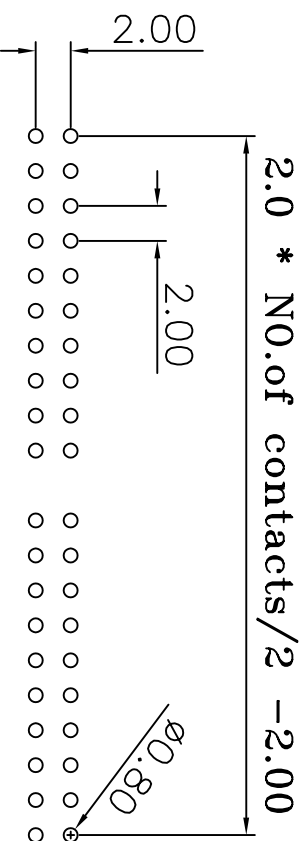

- (RoHS Compliant)  
(Halogen-Free)
- P2 L 45 P - 2 XX S0 BK X 000 X  
 1 2 3 4 5 6 7 8
- Standard: L= LCP
  - P=With Key 3.10mm
  - Per ROW: 03 to 40 pin
  - Taill Style: S0= Straight
  - Color: BK=Black WH=White
  - Contact Plated: T=Matte Tin over Nickel W=Matte Tin over Nickel Y=Bright Tin over Nickel C=Gold Flash F=Gold Flash,Matte Tin 100u" A=Gold 3u" B=Gold 3u",Matte Tin 100u"
  - Special Options: D=Gold 5u" E=Gold 5u",Matte Tin 100u" G=Gold 10u" J=Gold 10u",Matte Tin 100u" L=Gold 15u" M=Gold 15u",Matte Tin 100u" U=Gold 30u" V=Gold 30u",Matte Tin 100u"
  - Packging: B= Tube C= Tray



CONN TOP COMPONENT INC.

PART NO P2L45P-2XXS0BKX000X

.X .XX .XXX  
 ±0.3 ±0.20 ±0.100

1: P2L45P-2XXS0BKX000X  
 2: P2N45T-203833S  
 3: 0

DRAWING NO P20045-00058  
 DRAWN BY GARY  
 APPROVAL BY  
 EDITION: C  
 SCALE: 1:1  
 ITEM: P20045  
 UNT: m.m

TEL:(02)86481727 FAX:(02)86482427