

**2.0 \* No.of contacts/2**

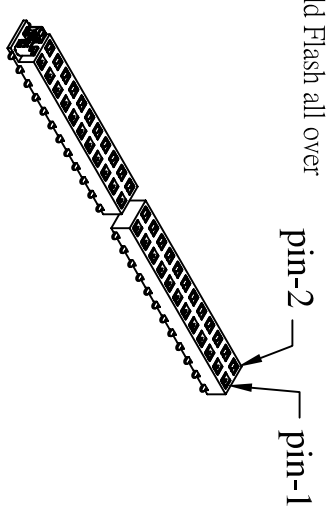

Current Rating: 2 Amps  
 Insulator Resistance: 5000 Megohms min  
 Contact Resistance: 20 m ohms max  
 Dielectric Withstanding: 500 V AC  
 Operating Temperature: -40° ~ +105° C  
 Max Processing Temp: 230° C for 60 seconds  
 260° C for 10 seconds  
 Contact Material: Phosphor Bronze  
 Insulator Material: Polyester, UL 94V-0  
 Standard: Nylon-6T  
 Finish: Tin, Gold Plated  
 Standard: Gold Flash all over

Recommended P.C. Board  
 SMD Layout

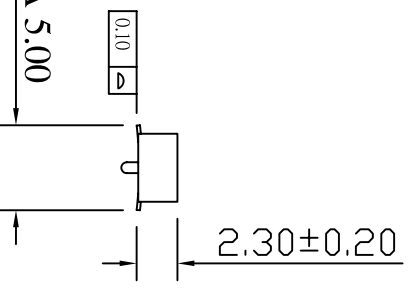
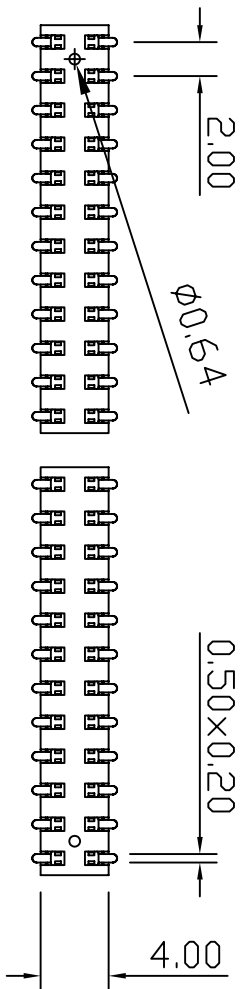
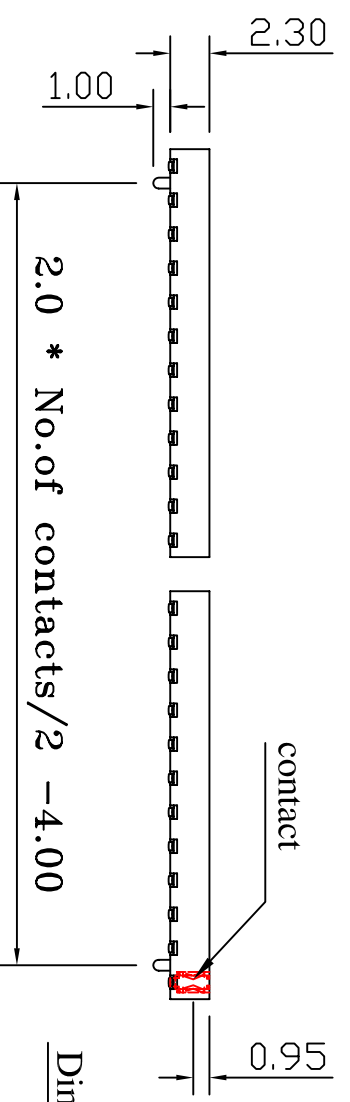
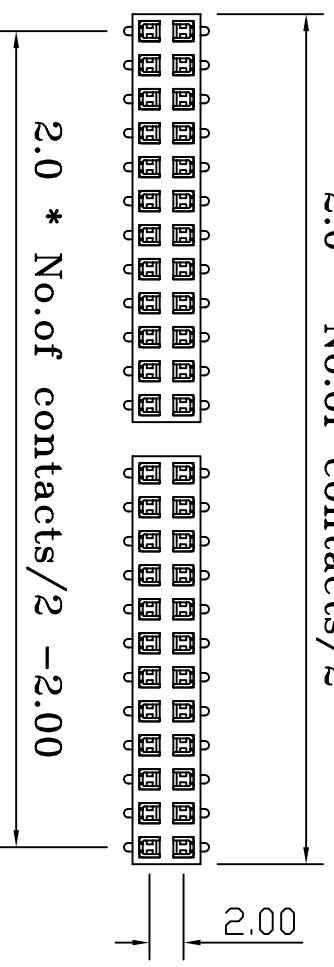
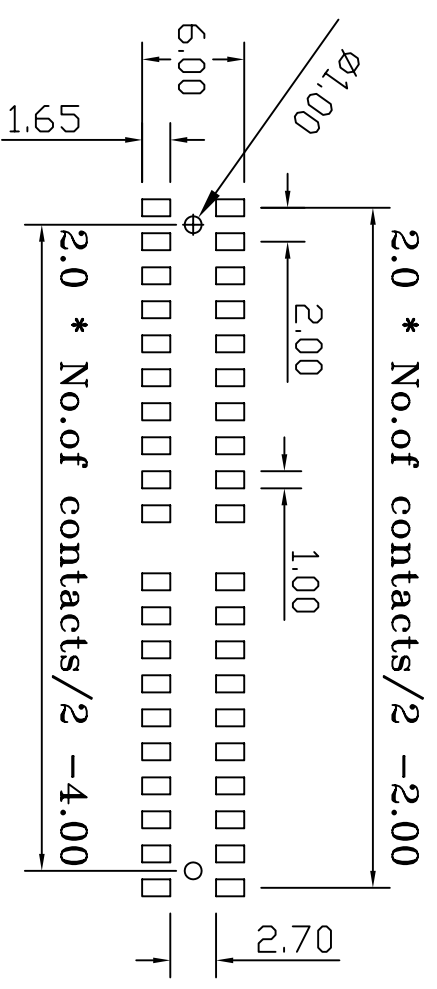

(RoHS Compliant)  
**P2 N 23-2 XX D1 BK X 000 B**  
 1 2 3 4 5 6 7

- Standard: Nylon-6T
  - Per RDW 03 to 40
  - Taill Style:
  - Color:
  - Contact Plated:
  - Special Options:
  - Packing:
- T=Matte Tin over Nickel  
 W=Matte Tin over Nickel 150u"  
 Y=Bright Tin over Nickel  
 C=Gold Flash  
 F=Gold Flash,Matte Tin 100u"  
 A=Gold 3u"  
 B=Gold 3u',Matte Tin 100u"  
 D=Gold 5u"  
 E=Gold 5u',Matte Tin 100u"  
 G=Gold 10u"  
 H=Gold 10u',Matte Tin 100u"  
 J=Gold 15u"  
 K=Gold 15u',Matte Tin 100u"  
 L=Gold 30u"  
 M=Gold 30u',Matte Tin 100u"  
 U=Gold 30u"  
 V=Gold 30u',Matte Tin 100u"  
 BK=Black



PART NO		P2N23-2XXD1BKX000B	
DRAWING NO		P200-00050	
DRAWN BY		GARY	
EDITION:		C1	
SCALE:		1:1	
ITEM:		P200	
UNIT:		m.m	

①: P2N23-2XXD1BKX000-2007/03/28-C  
 CONN TOP COMPONENT INC.  
 TEL: (02)86481727 FAX: (02)86482427