

Current Rating:  
 Insulator Resistance:  
 Dielectric Withstanding:  
 Contact Resistance:  
 Operating Temperature:  
 Max Processing Temp:  
 Max Processing Temp:  
 Contact Material:  
 Insulator Material:

1 Amps  
 5000 Megohms min  
 500 V AC  
 20 Mhm ohms max  
 -40° ~ +125° C  
 230° C for 60 seconds  
 260° C for 10 seconds  
 Copper Alloy  
 Polyester, UL 94V-0  
 Standard: LCP

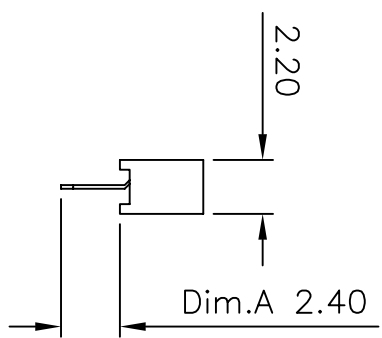

Recommended  
 P.C. Board Layout

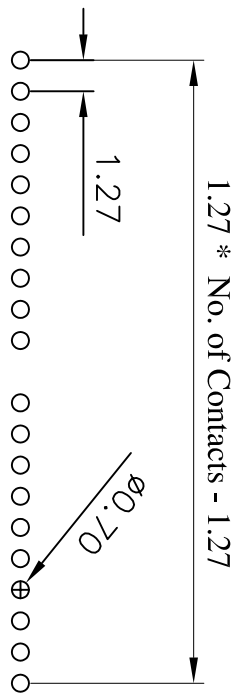
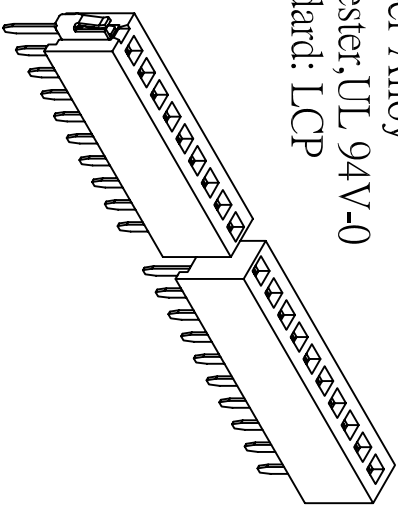

(RoHS Compliant)  
 (Halogen-Free)

P3 L 34 - 1 XX S0 BK X 000 X  
 1 2 3 4 5 6 7

- Standard: L=LCP
- Per ROW 02 to 50
- Tail Style:  
SO= Straight
- Color:  
BK=Black
- Contact Plated:  
C=Gold Flash  
A=Gold 3u"
- Special Options:  
D=Gold 5u"  
G=Gold 10u"  
L=Gold 15u"  
U=Gold 30u"  
B= Tube  
C= Tray

CONN TOP COMPONENT INC.		P3L34-1XXS0BKX000-2007/03/23-C	
1:	P3L34-1XXBKH0	PART NO	P3L34-1XXS0BKX000X
2:	P3L34T-1525-02S	DRAWING NO	P127-00007
3:	W055	DRAWN BY	LN
TEL:(02)86481727 FAX:(02)86482427		APPROVAL BY	
		EDITION:	C1
		SCALE:	1:1
		UNIT:	m.m
		X	±0.3
		XX	±0.20
		XXX	±0.100
		ITEM:	P127